

Lampholders for compact fluorescent lamps

26.745

G24 / GX24



pkg. wt.
250 10 g

part no. Key:
26.745.2311.50 d-1 (10 / 13 Watt)
26.745.2321.50 d-2 (18 Watt)
26.745.2331.50 d-3 (26 / 32 Watt)
26.745.2341.50 d (without key)*

For lamps TC-D, TC-T, TC-DEL, TC-TEL

Screw fixing horizontally

Housing: PBT

Approval: additional cULus (500 V)

- Long holes \varnothing 4.5 x 2.5 mm for screws ISO 1207 - M4
- Holes \varnothing 2.4 mm for self-tapping screws ISO 1481 - ST2.9 - F
- Please note the base diameter (max. \varnothing 61 mm) for lamps with base GX 24.
- If required screw fixing foot 26.745.-440. 50 and lampholders can be supplied separately
- *Note: Whilst the version of the lampholder without key is designed and constructed to the same high quality standards as the approved versions, there is no valid approval available that we can apply for.

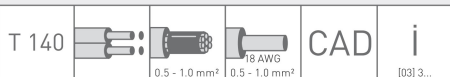
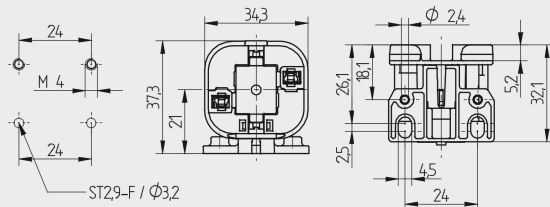

pkg. wt.
250 10 g

part no. Key:
26.745.2351.50 q-1 (8 / 10 / 13 Watt) / q-5 (57 Watt)**
26.745.2361.50 q-2 (18 Watt) / q-6 (70 Watt)***
26.745.2371.50 q-3 (26 / 32 Watt)
26.745.2381.50 q-4 (42 Watt)
26.745.2391.50 q-3+q-4 (26 - 42 Watt)
26.745.2401.50 d (without key)*

**Key q-5 only when used with adaptor 26.725.-420

***Key q-6 only when used with adaptor 26.725.-420

For lamps TC-D, TC-T, TC-DEL, TC-TEL

Screw fixing horizontally

Housing: PBT

Approval: additional cULus (500 V)

- Long holes \varnothing 4.5 x 2.5 mm for screws ISO 1207 - M4
- Holes \varnothing 2.4 mm for self-tapping screws ISO 1481 - ST2.9 - F
- Please note the base diameter (max. \varnothing 61 mm) for lamps with base GX 24.
- If required screw fixing foot 26.745.-440. 50 and lampholders can be supplied separately
- *Note: Whilst the version of the lampholder without key is designed and constructed to the same high quality standards as the approved versions, there is no valid approval available that we can apply for.

Find accessories on page: [03] 35

